

Montážní(y) návod 103.

Assembly instructions 103.

Montageanleitung 103.

FLEX

H-P RM 60 102
H-P RM 80 102

4 ks	
4 ks	
8 ks	
1 ks	
1 ks	
4 ks	
4 ks	

FEV 60 L	H-TEL 60 V S, H-P RM 60 102 (202), H-SKV RM 2, H-K FZ, H-N RK 14 FZ, H-KA 1, H-KA 3
FEV 60 P	H-TEP 60 V S, H-P RM 60 102 (202), H-SKV RM 2, H-K FZ, H-N RK 14 FZ, H-KA 1, H-KA 3
FE 2005 L	H-TEL 2005 S, H-P RM 80 102 (202), H-SKV RM 2, H-K FZ, H-N RK 14 FZ, H-KA 1, H-KA 3
FE 2005 P	H-TEP 2005 S, H-P RM 80 102 (202), H-SKV RM 2, H-K FZ, H-N RK 14 FZ, H-KA 1, H-KA 3

1a

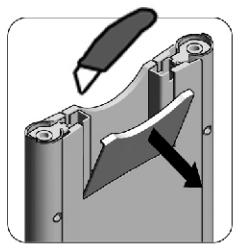

1b

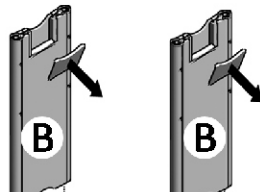

2a

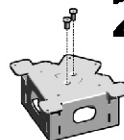

2b

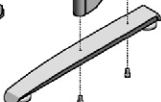
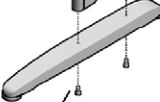
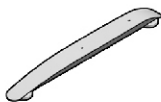

A alt. 1

A alt. 2

A

G alt. 1

G alt. 2

H-KA 1	4 ks	
H-KA 3	2 ks	

3

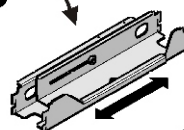

4

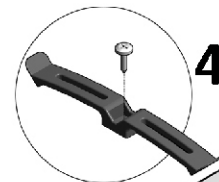

F

5

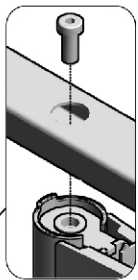

H-K FZ	2 ks	
	8 ks	
	1 ks	

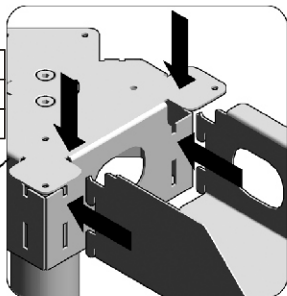

6

